

General dimensions

Units: mm

Figures in () are when wide shoes (option) are installed.

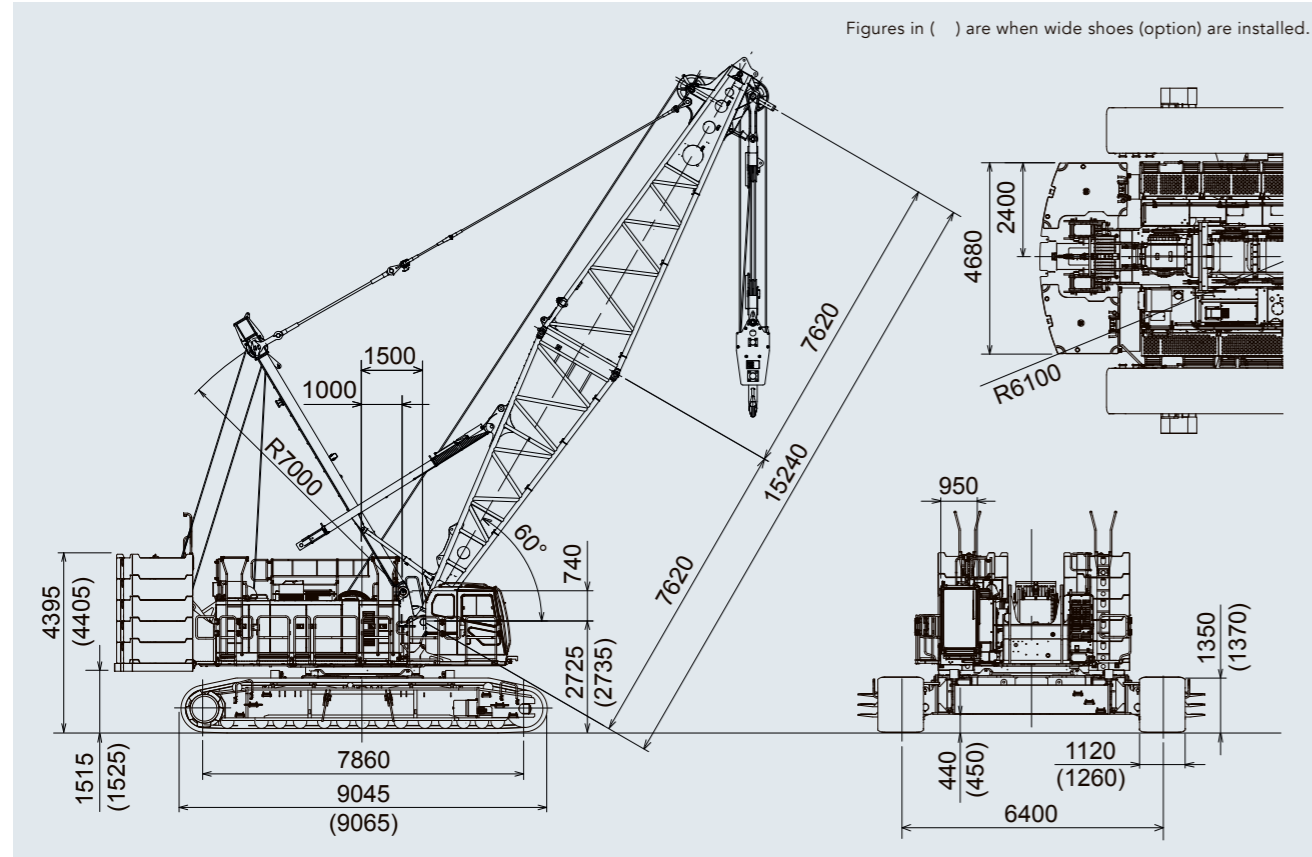

Specifications

Model		SCX2800A-3	
Application		Liftcrane	Luffing towercrane
Max. lifting capacity	t × m	275 × 4.3	80 × 9.3
Basic boom length	m	15.25	—
Max. boom length	m	91.45	—
Crane jib length	m	12.20 ~ 36.55	—
Max. boom + crane jib length	m	70.10 + 36.55	—
Tower length	m	—	21.35 ~ 60.95
Tower jib length	m	—	21.35 ~ 60.95
Tower + jib length	m	—	60.95 + 60.95
Rope line	Front/rear main drum	m/min	110 ~ 2
speeds (*1)	Boom hoist drum	m/min	30 × 2
	Tower jib hoist drum (Optional)	m/min	—
Swing speed	min ⁻¹ (rpm)	1.5	1.5
Travel speed high/low (*2)	km/h	1.0 / 0.5	1.0 / 0.5
Gradeability	% (°)	30 (17)	30 (17)
Engine	Make & model	Cummins QSL9 (Stage III A / Tier 3)	
	Rated output	kW/min ⁻¹ (PS/rpm)	280/2,000 (380/2,000)
Ground contact pressure	kPa (kgf/cm ²)	129.0	141.8
Operating weight	t	231	255
		With 15.25 m boom and 275 t hook	With 60.95 m tower, 60.95 m tower jib and 80 t hook block

Notes: 1. Rope line speeds vary under load and operating conditions (*1). 2. Travel speed is based on flat, level and firm supporting surface with no load and 15.25 m basic boom (*2).

- We are constantly improving our products and therefore reserve the right to change designs and specifications without notice.
- Units in this catalog are shown under International System of Units (SI). The figures in parenthesis are under the older British Gravitational System of Units.
- Illustrations may include optional equipment and accessories, and may not include all standard equipment.
- Standard equipment and accessories may vary by country and region.

Sumitomo Heavy Industries Construction Cranes Co., Ltd. has been abbreviated as "HSC" throughout this catalog. "HSC CRANES" is a brand of Sumitomo Heavy Industries Construction Cranes Co., Ltd.

Address inquiries to :

 Sumitomo Heavy Industries Construction Cranes Co., Ltd.
 9-3, Higashi-Ueno 6-chome, Taito-ku, Tokyo 110-0015, Japan
 Phone: 81-3-3845-1387 Facsimile: 81-3-3845-1394
<https://www.hsc-cranes.com>

Printed in Japan
2410©01H.EA370-1d

SCX
2800A-3





Further, Higher. New 275 t.

Building a better society for all, helping to make tomorrow brighter. To achieve such objectives, HSC embarked on development of the 275 t class crawler crane by endowing it with performance to meet a new day and age. Power and precision were of course elements deemed essential for reliable work, but HSC went above and beyond to incorporate additional features: better assembly to boost work efficiency; pioneering fuel efficiency and eco-friendly design; and safety and comfort for both crane operators and site operations.

The SCX2800A-3 delivers a superior level of performance in a more user-friendly package – all for building a better tomorrow. And with time-tested quality and sophisticated capability, the SCX2800A-3 is all about reaching for higher goals around the world.

SCX
2800A-3



SCX2800A-3 PERFORMANCE

High-performance 275 t lifting capacity to boost work sites.

The high-performance 275 t lifting capacity is ideal for building tomorrow. In addition to a powerful winch for steady operations, Eco winch mode also allows for streamlined operations and energy efficiency. Designed with a revolutionary approach for easier operation as well as the availability of wide shoes and reduction counter weight specifications, the SCX2800A-3 is built to meet an increasingly diverse range of job sites.



Max. lifting capacity
 Liftcrane : 275 t x 4.3 m
 Luffing towercrane : 80 t x 9.3 m

Swing neutral brake standardization



During work requiring the cab to swing (when the swing lever is in the neutral position), the operator may choose between free or brake mode depending on the work and personal preferences, making operations so much smoother.

Swing mode selector switch

Powerful winch

Equipped with a 13.5 t rated line pull winch for quick and powerful hoisting as well as ample performance for more complex operations. A wide winch drum design minimizes damage to winch ropes.

Ordinary operation

ECO winch mode

Minimal fuel consumption and high-speed winching with light loads

Simple operation

ECO winch mode is activated automatically using the ordinary control levers if the ECO winch switch is ON and certain operating conditions are met (hook only, 1150 rpm or lower engine speed).

Eco winch mode with high-speed winching and low-fuel consumption

Also included is a new Eco winch mode, which allows high line speeds under light loads without having to increase the engine speed (low rpm). This mode delivers outstanding workability in situations such as high-elevation construction sites and multiple rope hanging operations and also limits fuel consumption and noise as engine speed can be kept at a minimum.

Reduction counter weight specification OPTION

Reduction counter weight specification are available as an optional extra to provide added flexibility for a diverse range of worksites, including high locations and within tight internal areas where operating weight is limited or restricted (with counter weight detector).

Counter weight	Std	-1 layer	-2 layers	-3 layers
Total operating weight	231 t (233 t)	208 t (210 t)	173 t (175 t)	156 t (158 t)
Ground contact pressure	129 kPa (115 kPa)	116 kPa (104 kPa)	96.4 kPa (86.4 kPa)	87.0 kPa (78.0 kPa)

Note: Figures in () are when wide shoes (option) are installed. Reduction counter weight specifications are configured to suit crane specifications excluding the crane jib.

Wide 1,260 mm shoes OPTION

Wide shoes are available as an option that are 140 mm wider than the standard shoes. These help to reduce ground contact pressure (by approx. 8%) to suit a broader range of work types.



SCX2800A-3 CONTROL

Full command of precision control. Superior operations mean greater peace of mind.

The superior operating comfort of the advanced control system mean smooth movement exactly as intended, with an exceptionally sharp level of control. The result is unprecedented sophistication for lifting and moving, which are the essential requirements of cranes.



Tilt cab for better operator visibility

The SCX2800A-3 comes with a cab tilt mechanism that allows the cab to tilt back up to 18° to make moving loads at heights easier. The optimum work position suited to the job ensures the best possible operator visibility.



Control dials

Fine speed control dials for operations such as hoisting, lowering, swinging and boom hoisting are positioned in a central location on the left side console. Operations can be adjusted at will to suit the particular job.



Swing brake operation pedal **OPTION**

A swing brake operation pedal is available to ensure precise swing control under strong-wind situations. This allows brake control to be applied when swinging the cab around, resulting in precise swing control even on the harshest of worksites.

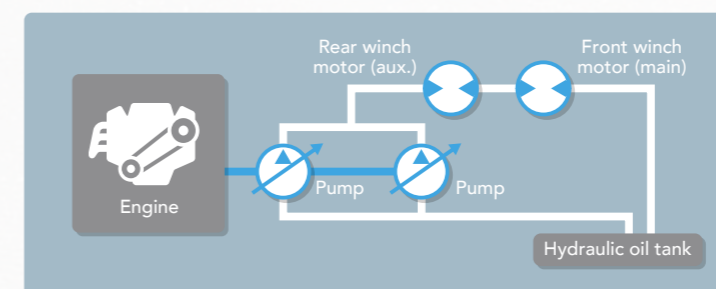

Combined hydraulic circuits

The hydraulic system uses HSC's own unique combined hydraulic circuit. By increasing and optimizing the pump pressure through the use of a mixed circuit to control the hydraulic oil from two hydraulic pumps, the sense of operability in traveling, hoisting/lowering, swing and boom hoisting can be enhanced. Even for multiplex operations, the latest hydraulic control system is able to support all tasks efficiently through priority control that match operating requirements. This helps to achieve a sense of operability that matches the intent of the operator.

SCX2800A-3 SAFETY

Reliable and precise. Advanced safety features for the unexpected.

Improving safety should come first and foremost. A simple, easy-to-view interface has been designed to ensure that information is provided to the operator in the most reliable way possible. Various accident prevention functions and multiple redundant safety devices have also been installed for protection against the unexpected. Work is covered by the utmost safety and reliability with a full complement of advanced safety equipment.

Moment limiter display

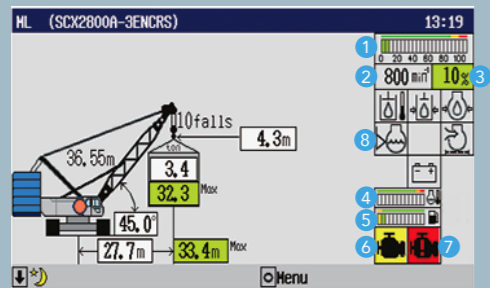

- 1 Load ratio indicator (%)
- 2 Engine speed
- 3 Load ratio (%)
- 4 Water temperature (engine coolant)
- 5 Fuel gauge
- 6 Engine trouble alarm (yellow)
- 7 Engine trouble alarm (red)
- 8 Warning icons

Moment limiter with large screen display

A large screen display has been used offering excellent visibility and field of view of any job. A host of items can be shown, while a simple display layout ensures that information is provided to the operator properly. The display has also been designed with an interactive interface to follow any movement of the crane from a safety perspective, which helps to limit unintended operations and maintain utmost safety.

ML Anti-two block

A new anti-two block using a lifting height indication device is offered as a standard equipment. When a height restriction is set in advance in the lifting height meter, the slowdown function will kick in as the restricted height is approached to prevent hook overhoist. Together with the anti-two block switch, the lifting height moment limiter provides a redundant level of safety against hook overhoist, leading to improved safety.

Note) This function plays a supplementary role to the existing moment limiter and use of this equipment alone is prohibited by laws and regulations.

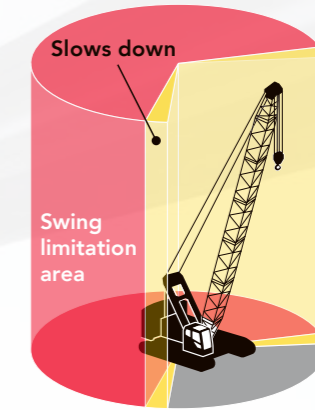

Swing restriction unit OPTION
Features a swing range alarm and automatic stop function. This option is designed to reduce the risk of accidents involving contact with objects, making work easier on confined sites.



Drum and rear view monitor system OPTION
A drum and rear view monitor system is available to help monitor winching and conditions behind the crane.

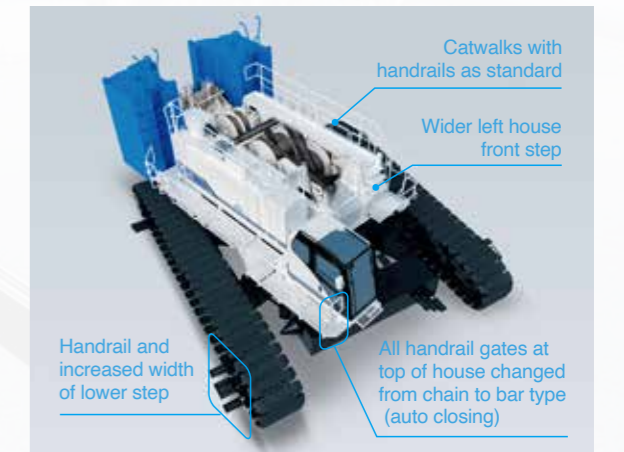

Safer and smoother access

Catwalks with handrails are now included as standard. Other changes to further enhance accessibility include a handrail added to the lower step, wider front step on the left of the house, and the use of bar type gates. Better accessibility ensures the utmost safety for all personnel working on job sites.

Note) Catwalks with no handrails are also available.

Other safety functions and devices

- Three color percentage indicator OPTION
- Independent winch operation lever locks
- Winch drum lock (front/rear)
- Anti-two block
- Gate lock lever
- Auto slowdown device
- Engine emergency stop switch
- Travel pedal lock

Enhanced visibility and smooth operations for greater comfort peace of mind.

Designed to make the stressful job of operators, more stress-free and more comfortable. Excellent visibility is just the start, and with easy-to-use accessories and an ergonomic control layout, the SCX2800A-3 is designed to make things smooth. These all help to reduce operator fatigue, while at the same time increasing comfort and functionality for maximum performance, day-in, day-out.



Better visibility in all directions

The cab has extra-wide windows to improve visibility in all directions.

Photos may differ to the specifications of available products.



Wide range of seat adjustments

More comfortable operator seat

The operator's seat provides superior comfort—the lower headrest caters to operators wearing helmets, while a new seat heater further increases comfort during work.



Insulated roof window glass

New insulating glass has been used for the roof window to shut out more than 90% of UV and mid-infrared light. This helps to prevent sunburn and ensure a more comfortable working space by limiting the rise in temperature.

Various items for more comfortable work



Cross operation lever **OPTION**



Wipers with greater sweep area



Sunshade



Cab roof window guard **OPTION**
 The photo is a different color to the standard color (black).



Control levers with drum rotation sensor

Control levers are designed for better operation with optimization made to the pitch, and a winch drum rotation sensor is also included. Any rotation in the winch is conveyed to the operator via the levers, for full control required for precision hoisting jobs. The result is smooth winching where accuracy is vital, such as positioning bolts with the crane.



Upper cabin controller

Controllers for the wipers, work lights, drum lock and other functions have been installed higher up near frequently used controls for a more natural layout.

Useful and functional interior accessories



Outside-air intake air-conditioner



Cup holder



Radio with Bluetooth®



Storage shelf

* European specification only.
 * The Bluetooth® work mark and logos are registered trademarks owned by Bluetooth SIG, Inc.

SCX2800A-3 ECOLOGY

Clean and economical. Environmentally-friendly for mankind and society.

A new greener engine delivers clean power required for our new generation of cranes. This advanced, environmentally-friendly technology ensures a more pleasant experience for everyone, surrounding towns, well into the future. Fuel consumption has been fine-tuned for more economic operation, which also presents major benefits from a management perspective.



Powered with a clean engine

Powered with an environmentally-friendly engine that is equivalent to EU stage III A and US Tier 3 emissions regulations. A major reduction in exhaust gas emissions and a reduction in fuel consumption help to decrease CO₂ emissions. The new engine and power train have been engineered to be even more environmentally-friendly.

Clean performance (EU)

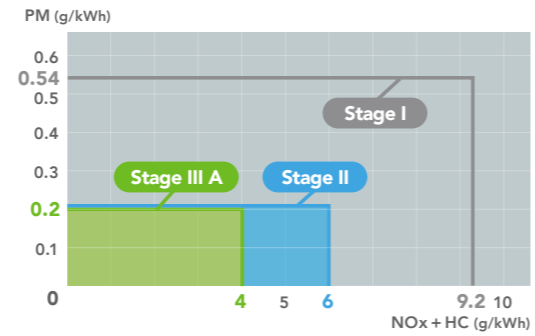

Compatible with biodiesel
The engine can also run on biodiesel and other BDF or HVO.
Note: Use HVO that meets European specification EN15940.
BDF: Bio Diesel Fuel HVO: Hydrotreated Vegetable Oil Contact our distributor for more details.

Other fuel efficiency technology



Auto idle stop function
Minimizes excess fuel consumption during work

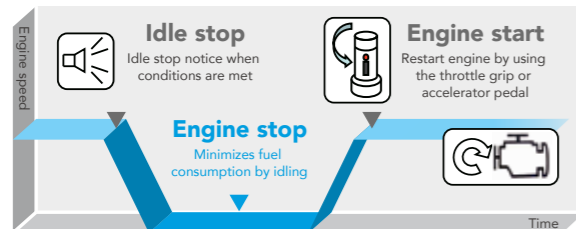

A new auto idle stop function is available for energy-efficient operation and minimal exhaust gas emissions. This prevents unnecessary idling during work to help reduce fuel consumption and limit the level of wear throughout various components. There is no impact on work, as the function stops the engine if the switch is ON and the required conditions are met, and restarts the engine when the accelerator is used.



ECO mode (see page 5 for details)
Reducing wastage during light load work, increasing productivity



Fuel economy has been improved drastically when winching up and down with light loads. This design ensures energy-efficient operation over repetitive movements or working with loads at heights.

SCX2800A-3 TRANSPORTABILITY

Superior transportation and assembly for advanced efficiency.

Designed to suit a diverse range of worksites and contemporary job needs, with outstanding crane performance and streamlined transportation and assembly. Complementing the enhanced self-assembly function is a setup process designed to reduce assembly time and maintain safe operations, giving worksites an unrivaled level of efficiency.



Counter weight self-assembly unit **OPTION**

An optional counter weight self-assembly unit is available to make self-assembly easier and to make the assembly process more efficient. The removable frame can be secured safely from ground level, and the number of counter weight fixing points on the crane has been reduced to further assist assembly.

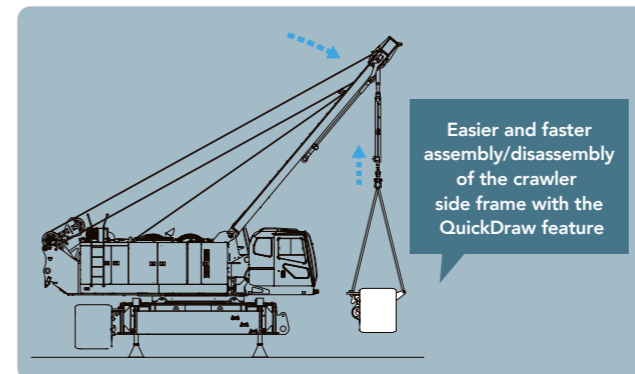

QuickDraw **OPTION**

QuickDraw is available for self-installation/removal of the heavy crawler side frame, lower weight, counter weight (including base weight), lower boom allowing assembly by smaller helper cranes. Other assembly procedures can be conducted at the same time, which further increases assembly efficiency.



Tower jib nesting mechanism **OPTION**

A new tower jib nesting mechanism is available to stow the tower jib inside the boom insert, achieving more efficient transportation and minimizing required storage space.

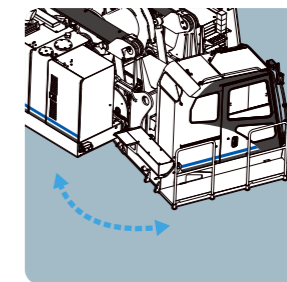

Swing cab mechanism

A swing cab mechanism has been incorporated as standard to achieve superior crane performance and transportability, allowing operators to switch quickly and easily back to the operating position.

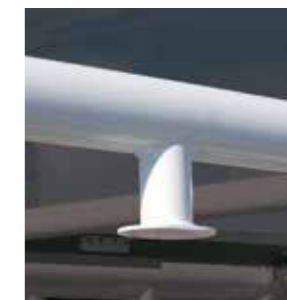

Extension boom with hanging lugs

The extension boom features hanging hooks designed to enhance assembly. The extension boom makes checking weight balance and other procedures easier, resulting in quicker assembly (crane boom only).

Other improvements to assembly

- Multi-assembly stage monitoring system
- Easier joint pin insertion/removal

Excellent support and peace of mind for ongoing work.



Utmost reliability on work sites

There are numerous ways to measure quality. Reliability that ensures peace of mind during daily operations is just one. HITACHI SUMITOMO has designed the SCX2800A-3 from early on in the development stage to deliver enhanced durability and ease of maintenance. Engineered with a safe design for improving operating capabilities and reducing running costs, HITACHI SUMITOMO cranes have evolved to deliver more benefits than ever before.

REMOTE SENSING



REMOTE SENSING as a watchful eye on the machine

Information on operating machines can be viewed at any time over the internet. Accurate data on operating conditions and parts replacement status help to reduce downtime and boost operating efficiency. The system also helps to cut maintenance time and costs with comprehensive machine management.



Map view

Maintenance data

Photos are for illustration purposes and may differ to actual products.

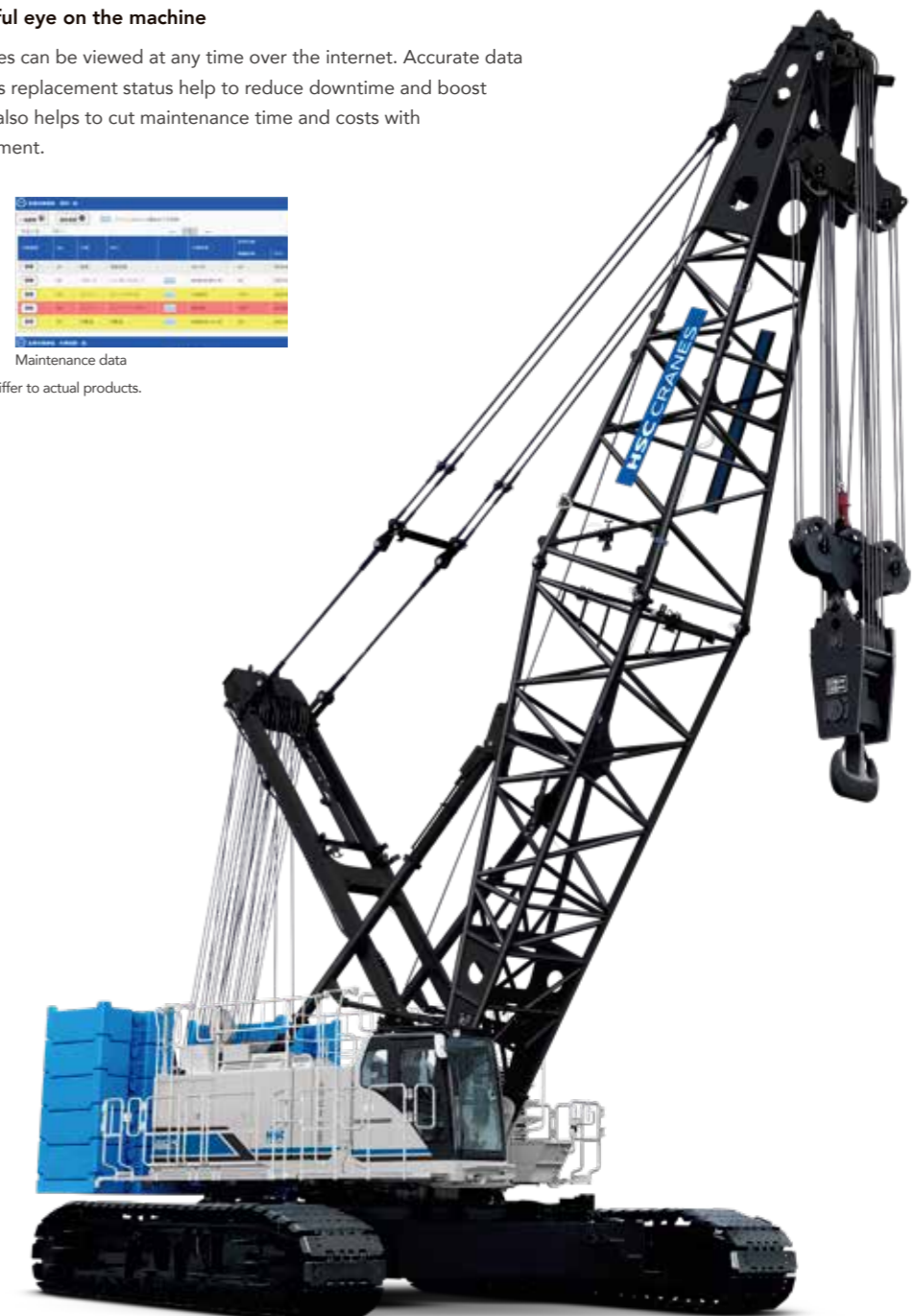

*Photos may differ to the specifications of available products.